

Presentation to

Wanaque Board of Education

July 21, 2015



a collaborative process

District Facility Analysis





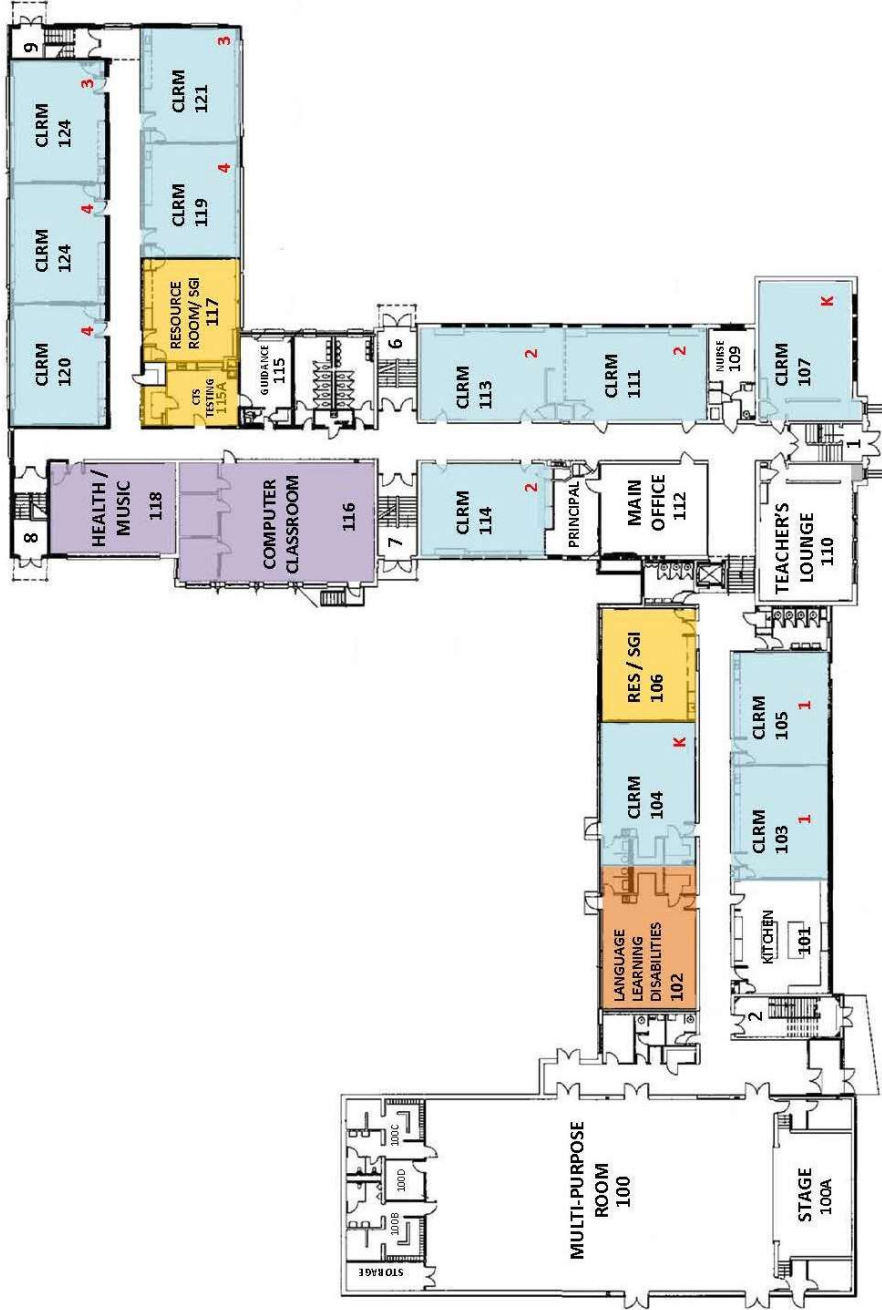

Agenda

- Introductions: **Di Cara | Rubino Architects** team
 - **Joseph A. Di Cara, AIA, LEED AP**
Firm Principal
 - **Allen Barnett, AIA, LEED AP**
Senior Project Manager
 - **Anthony S. DeNorchia**
Director of Educational Programs
- Purpose of Study
- Steps and Analysis
- Options
- Evaluation Process

Wanaque School District Existing Utilization



ROOM TYPE LEGEND

	CLASSROOM
	PULL-OUT SPACES
	SELF CONTAINED SPECIAL ED SPACES
	SPECIAL GROUP INSTRUCTION (SGI) SPACES
	AVAILABLE SPACE

1st Floor Plan – Haskell School
EXISTING ROOM NUMBERS AND NAMES

good enough never is

Wanaque School District Existing Utilization

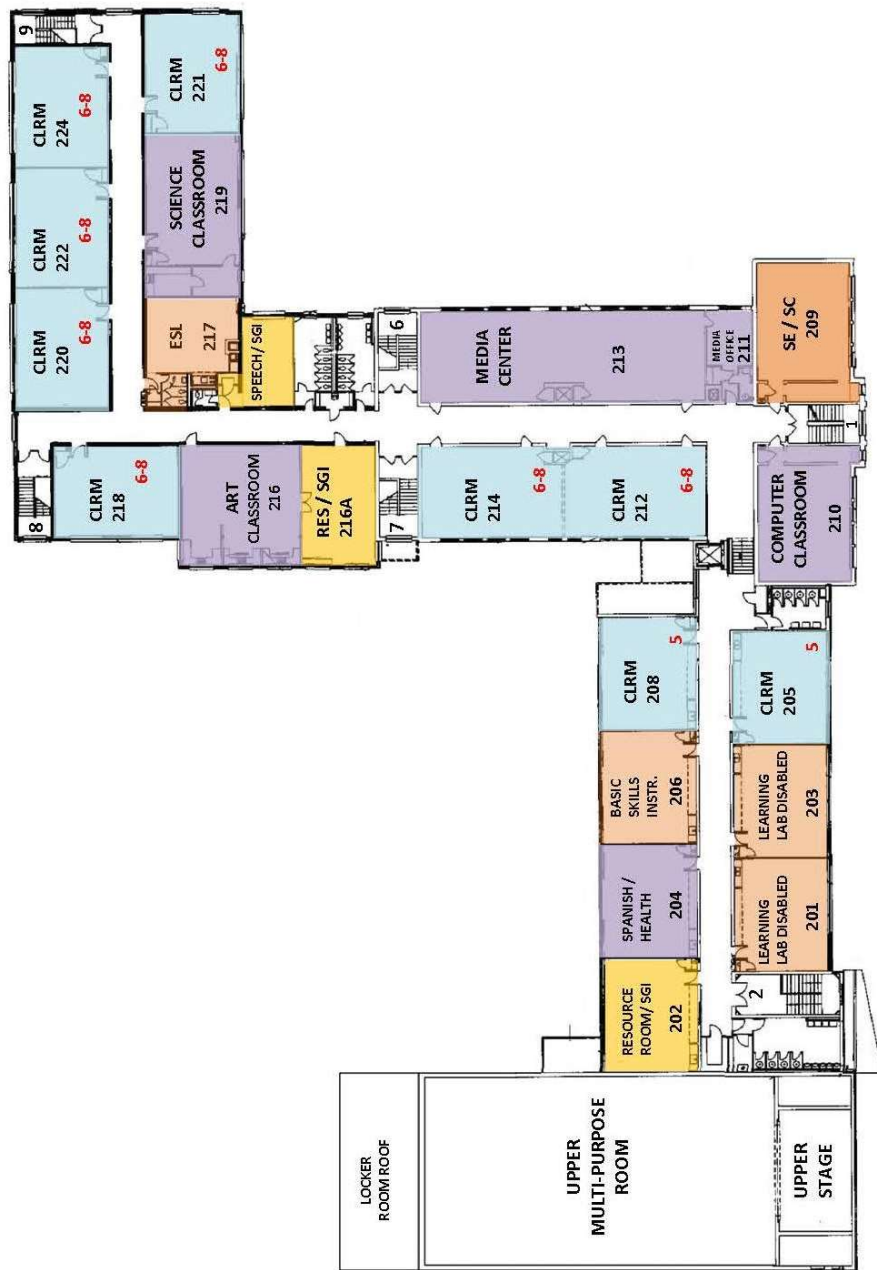

ROOM TYPE LEGEND

- CLASSROOM
- PULL-OUT SPACES
- SELF CONTAINED SPECIAL ED SPACES
- SPECIAL GROUP INSTRUCTION (SGI) SPACES
- AVAILABLE SPACE

2nd Floor Plan – Haskell School EXISTING ROOM NUMBERS AND NAMES

good enough never is

Wanaque School District Existing Utilization

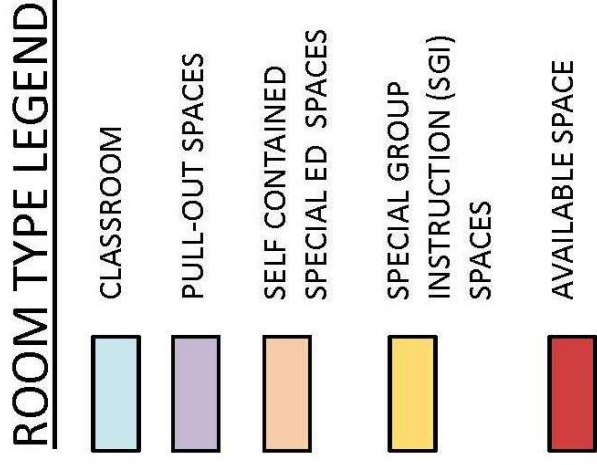
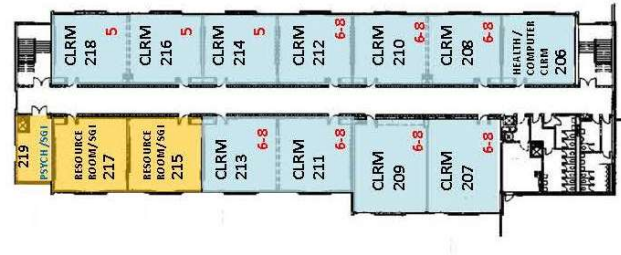
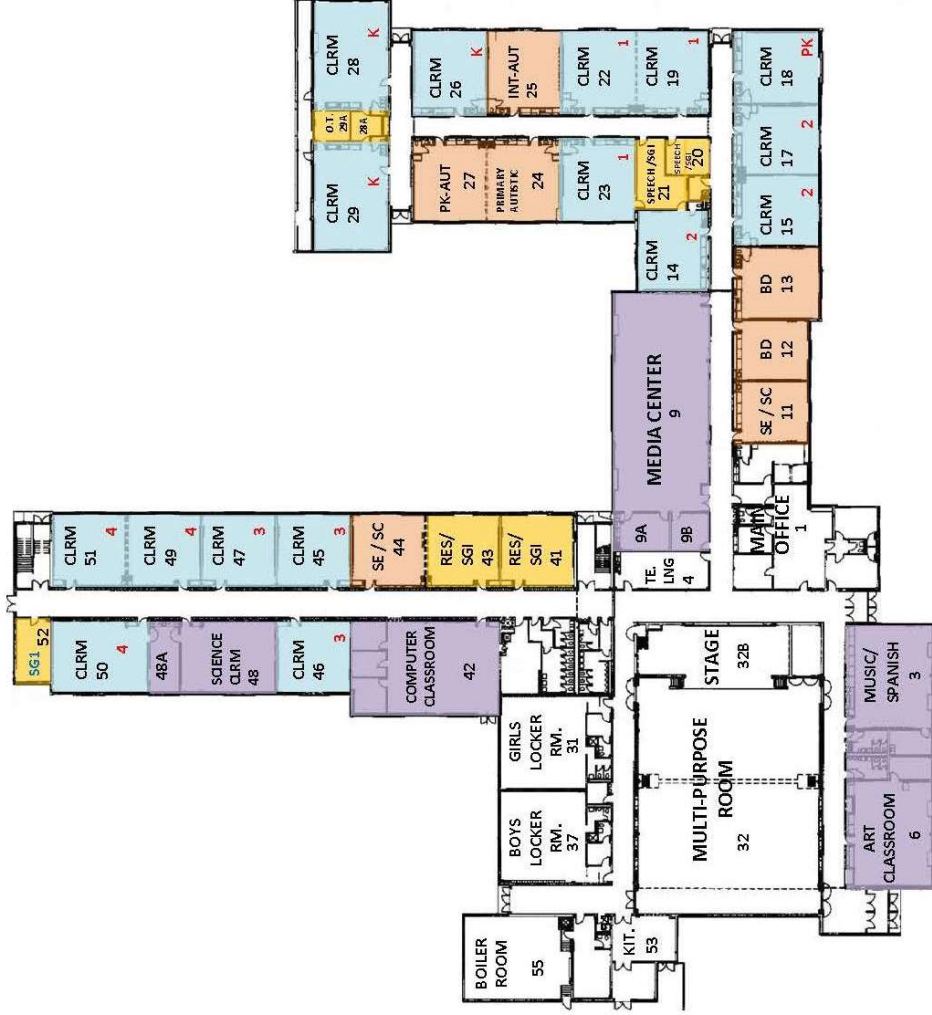

2nd Floor Plan

1st Floor Plan – Wanaque School
EXISTING ROOM NUMBERS AND NAMES

HASKELL SCHOOL

OPTION 1 - CURRENT UTILIZATION GRADES PRE-K - 8

SPACE	NJDOE F.E.S. #students	NJDOE FES Clrm. sq. ft.	2014/15 Existing			District Modified Enrollment			Needs # rm,s
			# rm,s	Enrol	CR Size	# rm,s	reqd # rm,s	Act'l students per rm	
Grade Level									
Pre-K	15	950	0	0	0	1.0	1	15	1
Kindergarten	21	950	2	45		2.1	2	22	0
1	21	850	2	45		2.1	2	19	0
2	21	850	3	50		2.4	3	21	0
3	21	850	2	35		1.7	2	19	0
4	23	800	3	36		1.6	2	18	-1
5	23	800	2	44		1.9	2	22	0
6, 7 and 8	23	800	7	134		7.3	8	17	1
sub-total			21	389			22		1
Self-Contained Sp. Ed / ILLD / BD	12	600	4	31			4	6	0
total			25	420			26		1
SGI/ Res. Rm/ Psych.		400	5				5		0
Basic Skills Instr.		400	1				1		0
ESL		400	1				1		0
PK - Autistic		800	0				0		0
Primary - Autistic		800	0				0		0
Intermediate - Autistic		800	0				0		0
CST		125	1				1		0
Health / Spanish Clrm.		800	1				1		0
Science Classroom		1,200	1				1		0
Computers		850	1				1		0
sub-total			11				11		0
Media Center		3,750	1				1		0
Multi-Purpose Rm		4,000	1				1		0
Art Classroom		1,250	1				1		0
Music / Spanish Clrm.		1,250	0				0		0
Music / Health Clrm.		1,250	1				1		0
sub-total			4				4		0

WANAQUE SCHOOL

OPTION 1 - CURRENT UTILIZATION GRADES PRE-K - 8

SPACE	NJDOE F.E.S. #students	FES Clrm. sq. ft.	2014/15 Existing		District Modified Enrollment			Needs # rm,s
			# rm,s	Enrol	CR Size	# rms	reqd # rms	
Grade Level								
Pre-K	15	950	1	15		1	15	0
Kindergarten	21	950	3	57		3	19	0
1	21	850	3	48		3	16	0
2	21	850	3	55		3	18	0
3	21	850	3	59		3	19	0
4	23	800	3	59		3	19	0
5	23	800	3	55		3	18	0
6, 7 and 8	23	800	7	169		8	21	1
sub-total			26	517		27		1
Self-Contained Sp. Ed / LLD / BD	12	600	4	38		4	10	0
total			30	555		31		1
SGI/ Res. Rm/ Psych.		400	9			9		0
Basic Skills Instr.		400	0			0		0
ESL		400	0			0		0
PK - Autistic		800	1			0		-1
Primary - Autistic		800	1			1		0
Intermediate - Autistic		800	1			1		0
CST		125	0			0		0
Health / Spanish Clrm.		800	0			0		0
Science Classroom		1,200	1			1		0
Comp / Health Clrm.		850	1			1		0
sub-total			14			13		-1
Media Center		3,750	1			1		0
Multi-Purpose Rm		4,000	1			1		0
Art Classroom		1,250	1			1		0
Music / Spanish Clrm.		1,250	1			1		0
Music / Health Clrm.		1,250	0			0		0
sub-total			4			4		0

District Facility Analysis

OPTION		HASKELL		WANAQUE				
1	A.	Pre-K – 8	N +1	N+1 CL	Pre-K – 8	0		
	B.							
2	A.	Pre-K – 5	N +15	N +11 CL N +4 SE	Grade 6 – 8	S -13	S -9 CL S -4 SE	
	B.	Grade 6 – 8	S -8	S -4 CL S -4 SE	Pre-K – 5	N +10	N +6 CL N +4 SE	
3	A.	Pre-K – 4	N +8	N +6 CL N +2 SE	Grade 5 – 8	S -6	S -4 CL S -2 SE	
	B.	Grade 5 – 8	S -2	N +1 CL S -3 SE	Pre-K – 4	N +1	N +1 CL 0	
4	A.	Pre-K – 3	S -1	N +1 CL S -2 SE	Grade 4 – 8	0	N +1 CL S -1 SE	
	B.	Grade 4 – 8	N +8	N +6 CL N +2 SE	Pre-K – 3	S -8	S -4 CL S -4 SE	

Wanaque School District Option 1: Grades Pre-K – 8

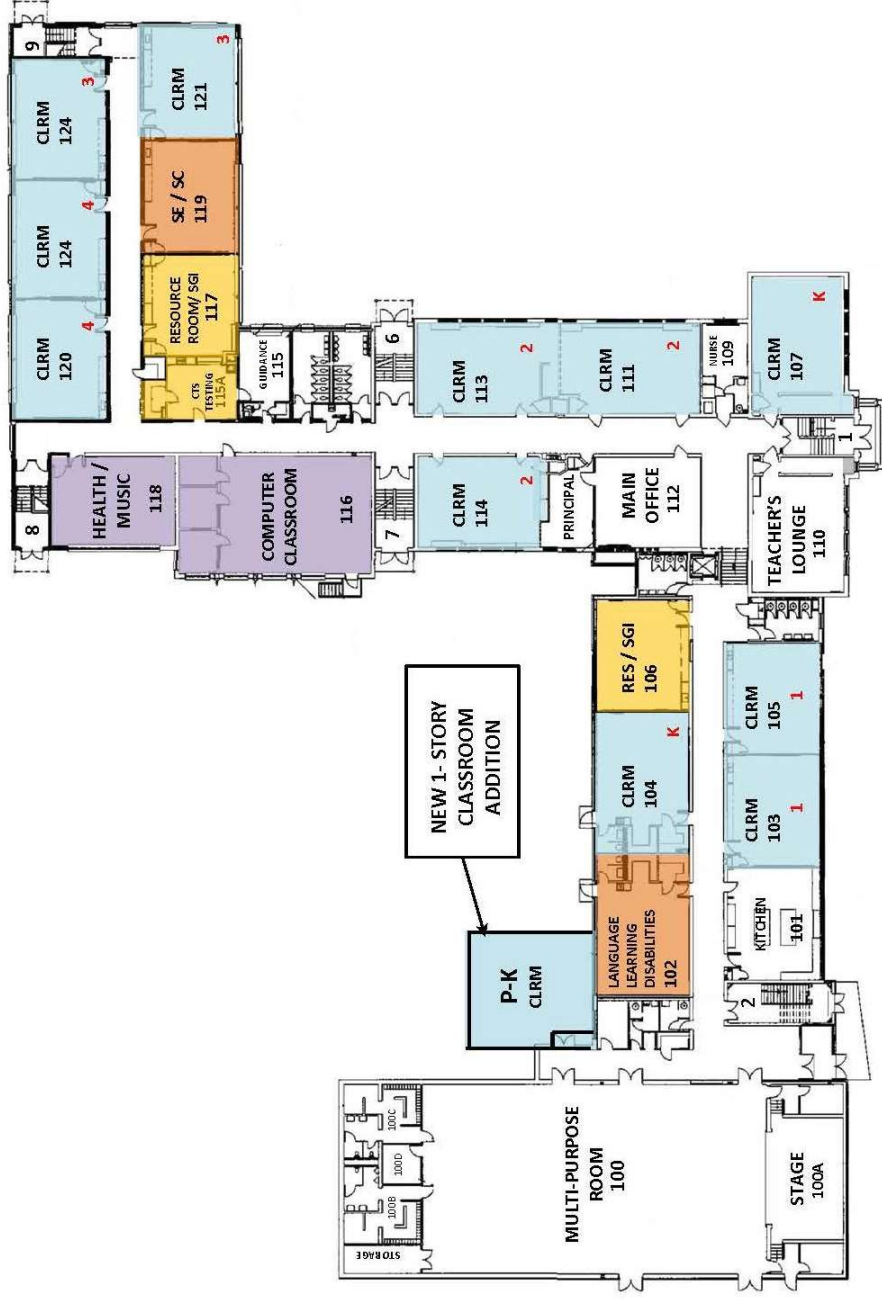

ROOM TYPE LEGEND

- CLASSROOM
- PULL-OUT SPACES
- SELF CONTAINED SPECIAL ED SPACES
- SPECIAL GROUP INSTRUCTION (SGI) SPACES
- AVAILABLE SPACE

1st Floor Plan – Haskell School

good enough never is

Wanaque School District Option 1: Grades Pre-K – 8

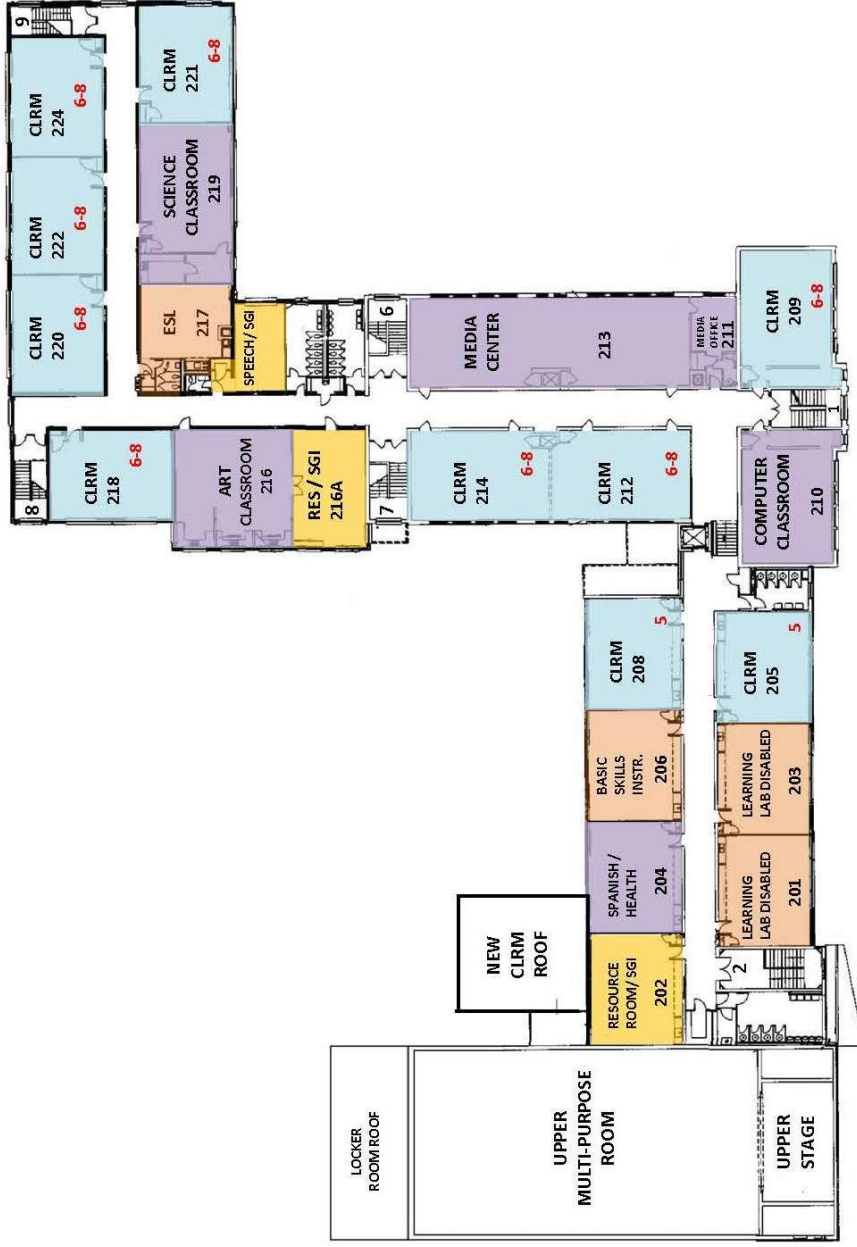

ROOM TYPE LEGEND

- CLASSROOM
- PULL-OUT SPACES
- SELF CONTAINED SPECIAL ED SPACES
- SPECIAL GROUP INSTRUCTION (SGI) SPACES
- AVAILABLE SPACE

2nd Floor Plan – Haskell School

Wanaque School District Option 1: Grades Pre-K – 8

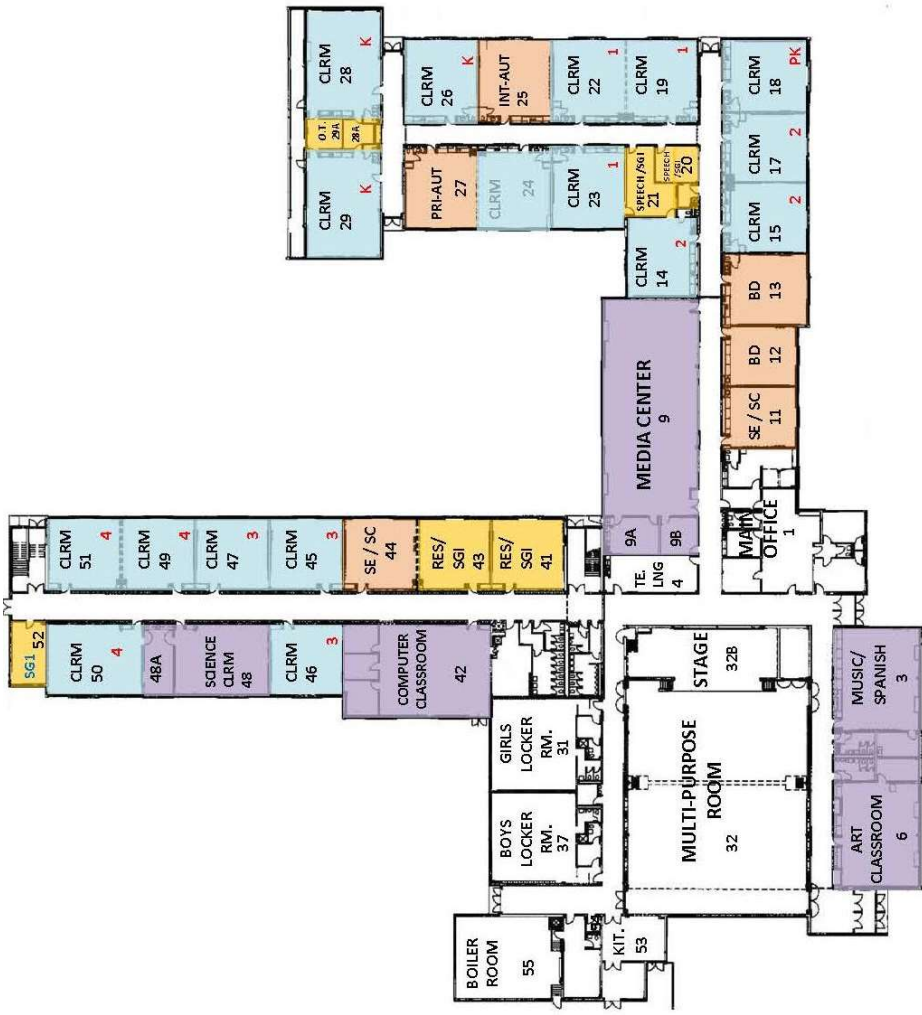



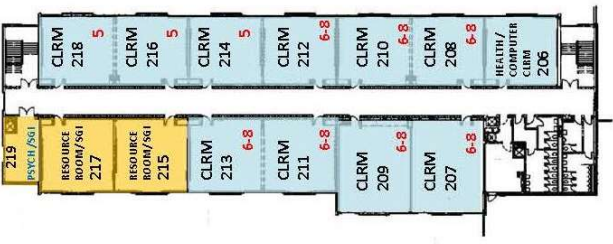

1st Floor Plan – Wanaque School



2nd Floor Plan





ROOM TYPE LEGEND

	CLASSROOM
	PULL-OUT SPACES
	SELF CONTAINED SPECIAL ED SPACES
	SPECIAL GROUP INSTRUCTION (SGI) SPACES
	AVAILABLE SPACE

Wanaque School District

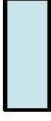
Option 3: Grades Pre-K – 4

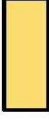
ROOM TYPE LEGEND

	CLASSROOM
	PULL-OUT SPACES
	SELF CONTAINED SPECIAL ED SPACES
	SPECIAL GROUP INSTRUCTION (SGI) SPACES
	AVAILABLE SPACE

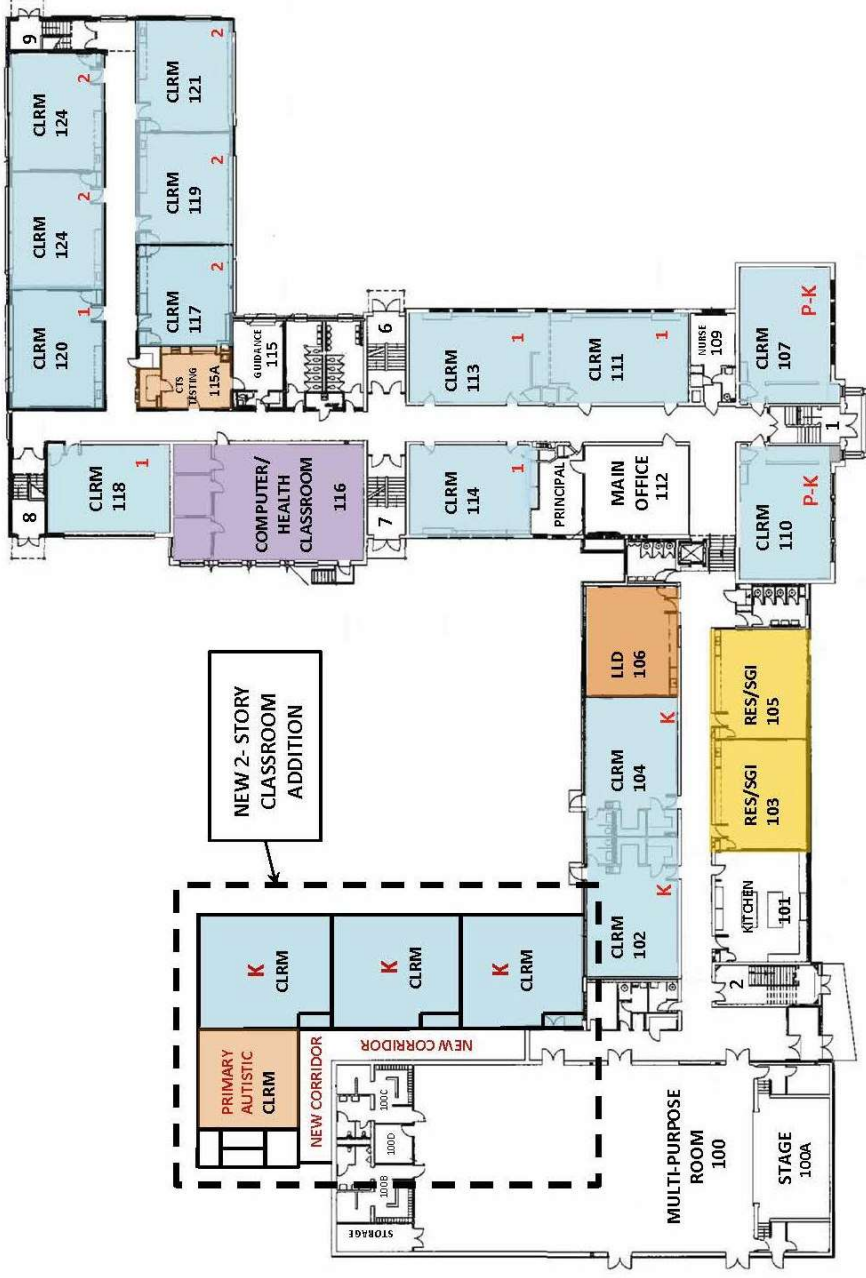

1st Floor Plan – Haskell School

Wanaque School District Option 3: Grades Pre-K - 4

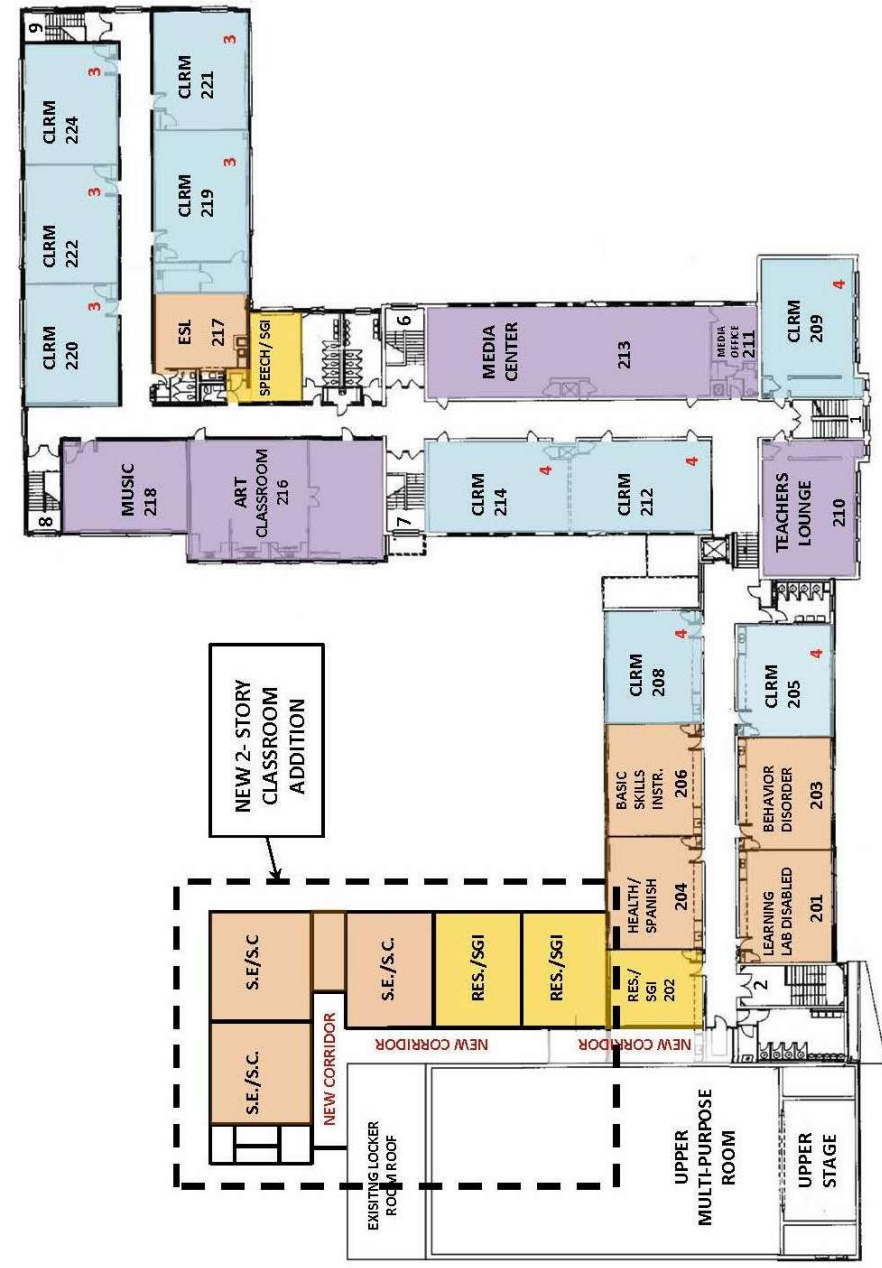

ROOM TYPE LEGEND

- CLASSROOM
- PULL-OUT SPACES
- SELF CONTAINED SPECIAL ED SPACES
- SPECIAL GROUP INSTRUCTION (SGI) SPACES
- AVAILABLE SPACE

2nd Floor Plan – Haskell School

Wanaque School District Option 3: Grades 5 – 8



1st Floor Plan – Wanaque School

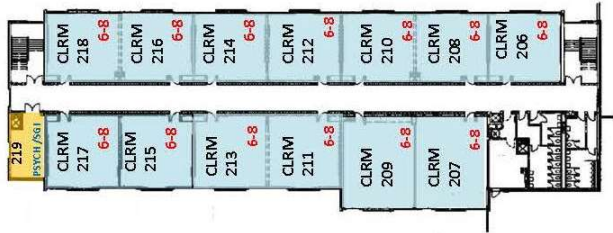



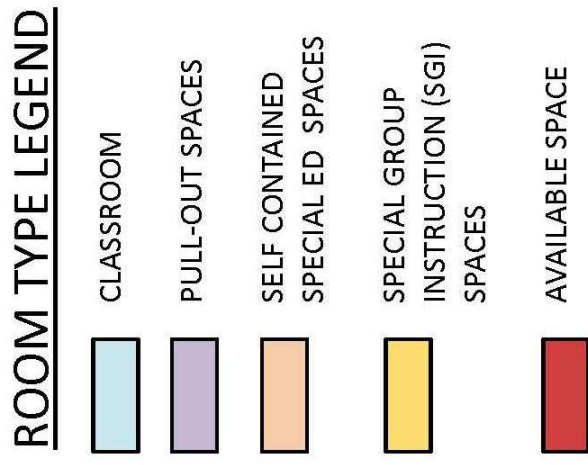

2nd Floor Plan

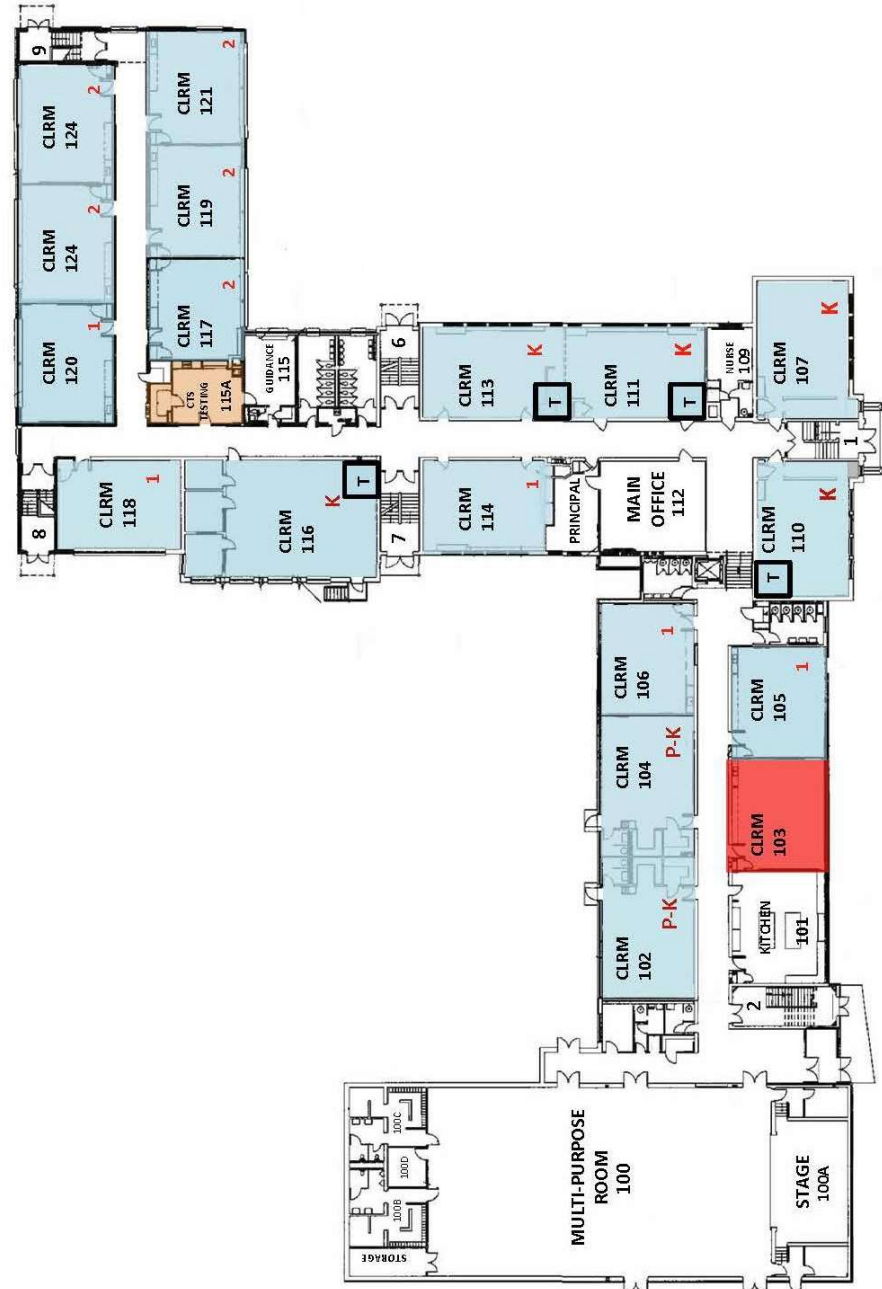

Wanaque School District Option 4: Grades Pre-K – 3



ROOM TYPE LEGEND

	CLASSROOM
	PULL-OUT SPACES
	SELF CONTAINED SPECIAL ED / SMALL GROUP INSTRUCTION
	AVAILABLE SPACE

1st Floor Plan – Haskell School

good enough never is

Wanaque School District Option 4: Grades Pre-K – 3

ROOM TYPE LEGEND

- CLASSROOM
- PULL-OUT SPACES
- SELF CONTAINED SPECIAL ED/ SMALL GROUP INSTRUCTION

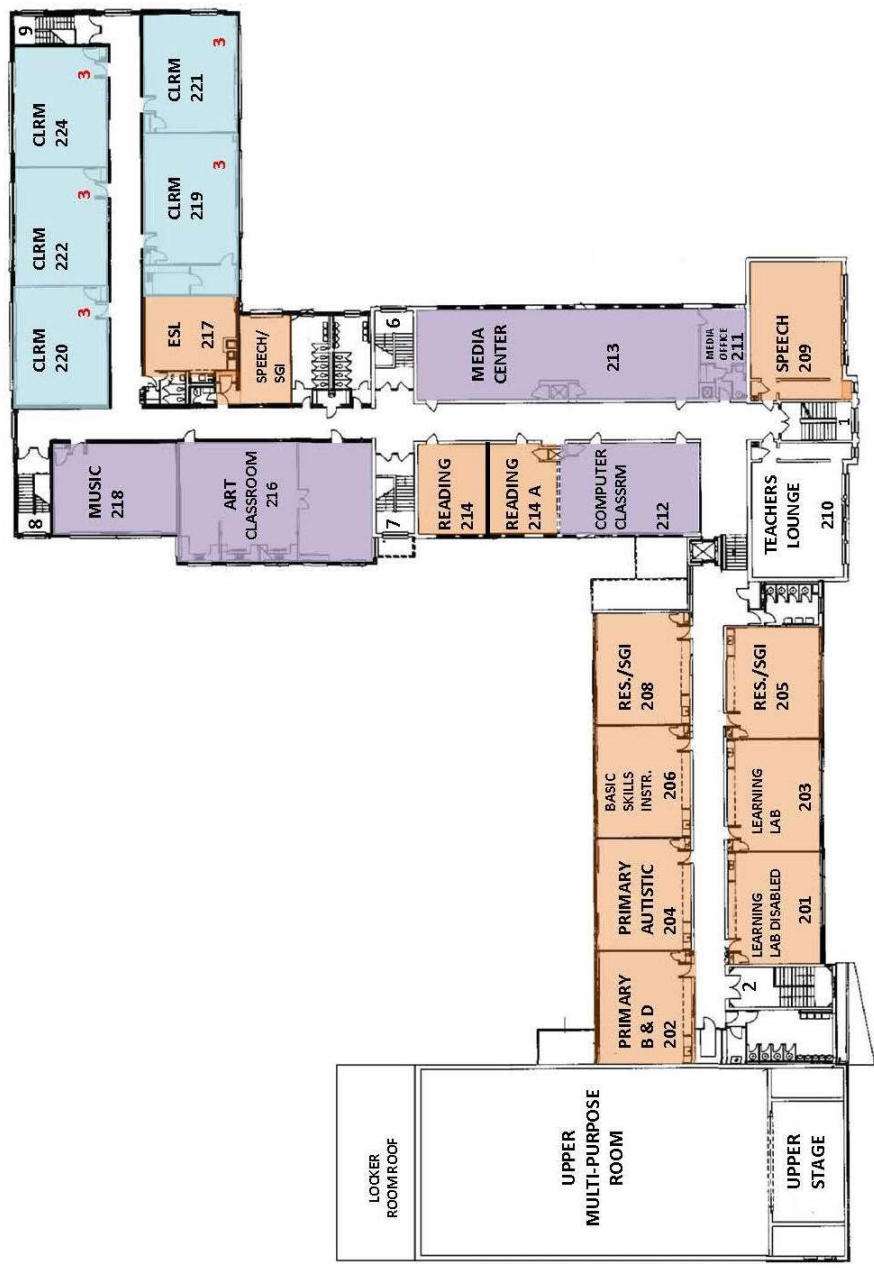

2nd Floor Plan – Haskell School

good enough never is

Wanaque School District Option 4: Grades 4 – 8

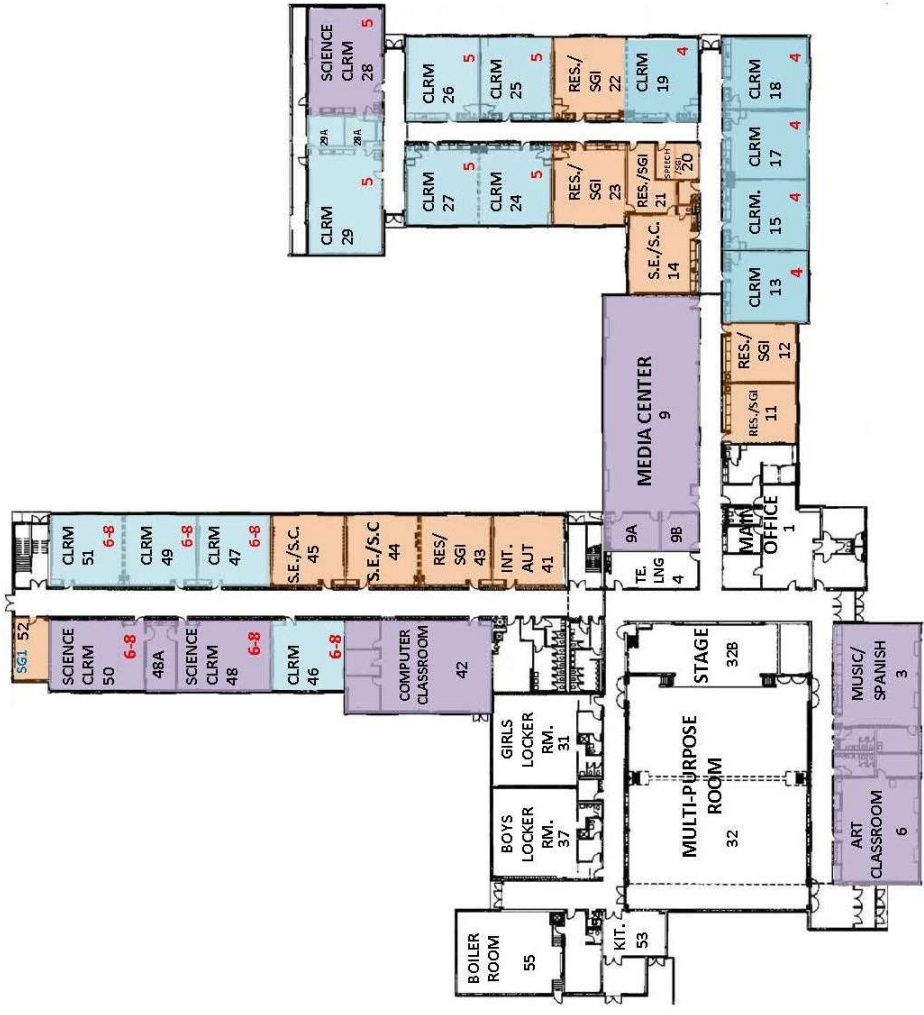

1st Floor Plan – Wanaque School

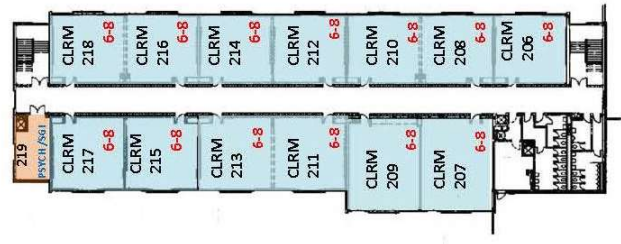

2nd Floor Plan

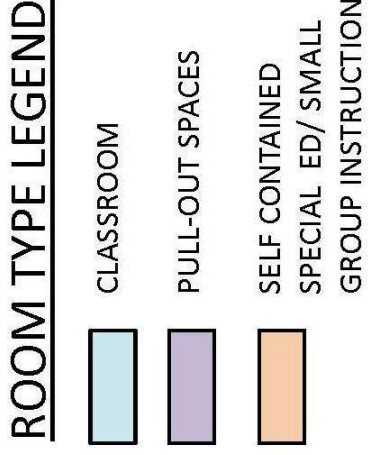

Next Steps

Evaluations

- Public input
- Transportation / Traffic Study
- Additional meetings with Board of Education and district administration
- Develop costs
- Review operating expenses

Comments & Questions